

# UNDERBAR BEER BIN

UNDERBAR - BEER BIN



## MATERIALS

- 18 Gauge, 304 Series Stainless Steel
- 1/2" NPT Drain (includes hose end valve)
- 6" Stainless Legs (1-5/8" O.D)
- Adjustable Stainless Bullet Feet
- Foam Insulation

## FEATURES

- Holds (12) cases of beer bottles
- 3" Backsplash
- 18" Deep Insulated Bin
- Compatible with Casters (3TP-5-PU-B-TLB & 3TP-5-PU-B) to convert into mobile equipment.

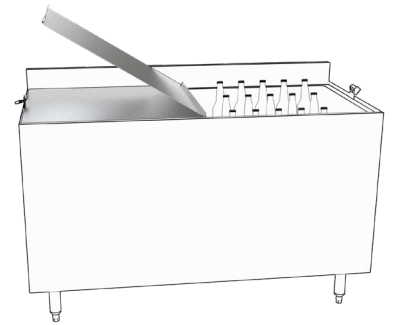

## ADD A - LOCKING COVER

- Locking Hinged Cover: ***IBB-L48***
- 18 Gauge, 304 Stainless Steel
- Includes Padlocks and Keys
- *\*Cover Can Not Be Used During Normal Operation*

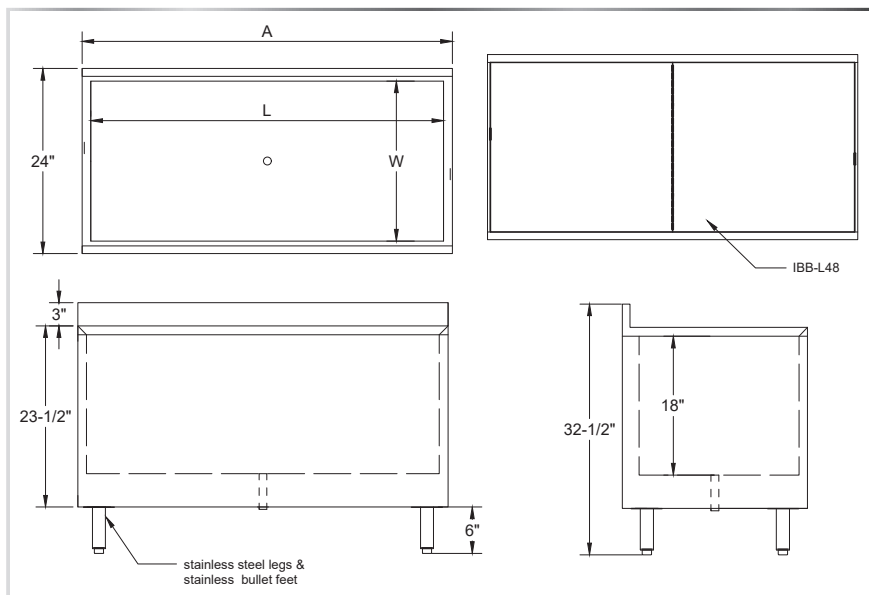

MODEL NUMBER	LENGTH	WIDTH	BIN SIZE L" X W" X H"	LONGNECK BOTTLE CAPACITY
IBB-4824	48"	24"	45-3/4" x 20-3/4" x 18"	12 Cases

(609) 642 - 8389 | SALES@NBREQUIPMENT.COM | WWW.NBREQUIPMENT.COM

NBR EQUIPMENT, 10 ABEEL ROAD, CRANBURY, NJ 08512