



60"-72" Modular Bar Stations with Liquor Displays

Material

- 18GA T304 top & base
- Stainless steel legs & adjustable bullet feet

Details

- Ice bin with cold plate: 1/2" NPS
- Ice bin without cold plate: 1" NPS
- Sink: 1-1/2" NPS

Features

- 24" Depth front to back, 3"H backsplash, 32-1/2" overall Height
- 36" Length Ice Bin, NIB-3618 or NIB-3618C10
- Blender dump sink, NBS-1224H or NBS-1824H
- Liquor Display, NLD-1224 or NLD-1824
- Single speed rail, NSR-36
- Removable bottle wells, BW3-18



Model	Overall Length (A)	Ice Bin Length (B)	Blender Dump Sink Length (C)	Liquor Display Length (E)	Drainboard Style	Ice Capacity (lbs)	Cold Plate Circuits	Weight (lbs)
N24-3LD60	60"	36"	12"	12"	Recessed	100		144
N24-3LD66	66"	36"	12"	12"	Recessed	100		149
N24-3LD72	72"	36"	18"	12"	Recessed	100		153
N24-3LD60C10	60"	36"	12"	12"	Recessed	100	10	229
N24-3LD66C10	66"	36"	12"	12"	Recessed	100	10	234
N24-3LD72C10	72"	36"	18"	12"	Recessed	100	10	238

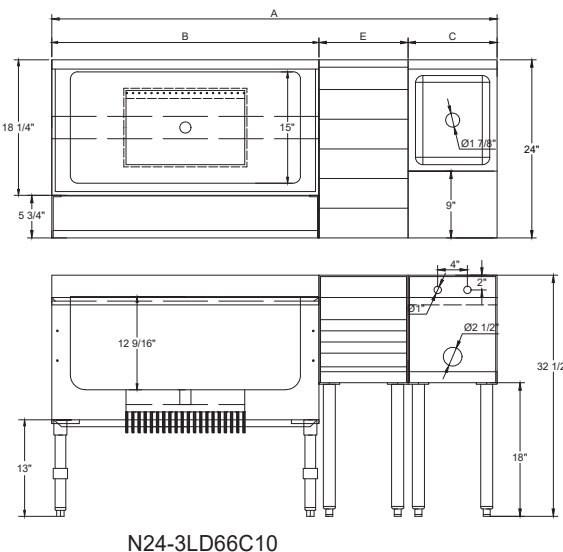
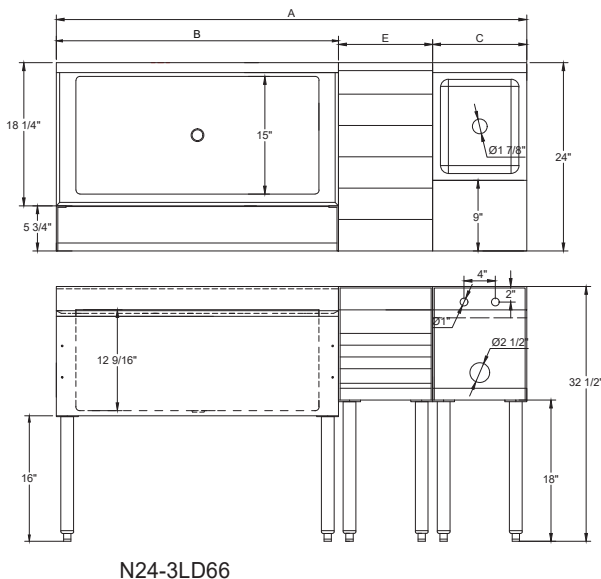

UNDERBAR - WORKSTATIONS

