

DOUBLE STORAGE MOP SINK CABINET

MOP SINKS - CABINET



MATERIALS

- 18 Gauge 430 Series Stainless Steel Body
- 16 Gauge 304 Stainless Steel Mop Sink
- 20 Gauge 430 Series Stainless Steel Doors

FEATURES

- Holds Two Mops
- One Fixed Overhead Shelf Above Mop Sink
- Three Fixed Shelves in Cabinet Storage Side
- 20" x 16" x 8" Mop Sink
- Two Hinged Doors With Transverse Rod Handles and Keyed Locks
- Double Storage Closet With Slanted Top
- Drain Basket Included

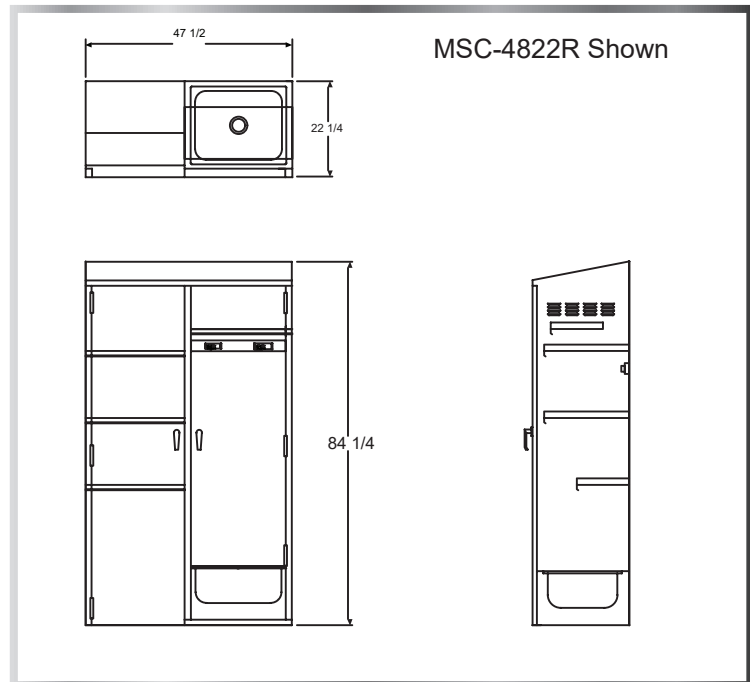

Include a Service Faucet (P2SV) as Seen on Page 86

| MODEL NUMBER | BOWL SIZE L X W X H | LENGTH | WIDTH |
|--------------|---------------------|---------|---------|
| MSC-4822L | 20" x 16" x 8" | 47-1/2" | 22-1/4" |
| MSC-4822R | 20" x 16" x 8" | 47-1/2" | 22-1/4" |