

HOT FOOD COUNTER WITH OPEN WELLS



FEATURES

- 12" x 20" Open Wells
- Individual Infinite Controls with Indicator Lights.
- 3/8" Thick x 8" Wide Poly Cutting Board.
- Adjustable Stainless Steel Legs
- 500W per well (120v).
- Three Wells: NEMA plug 5-20
- Four Wells: NEMA plug L5-30

MATERIALS

- 20 Gauge 304 Stainless Steel
- Stainless Steel Feet



*Enclosed Base Model (HT-4W-120B)

Add Water Pans (HT-1P), an Overshelf & Casters to your Hot Food Counter!
(See Page 9 or 130)



*Top view of HT-3W-120(B)

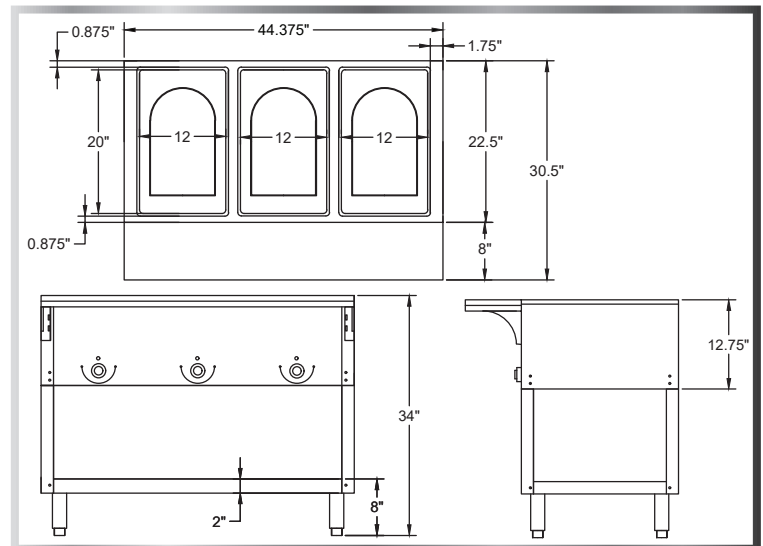

MODEL NUMBER	LENGTH	WIDTH
HT-3W-120	44- ³ / ₈ "	30- ¹ / ₂ "
HT-3W-120B	44- ³ / ₈ "	30- ¹ / ₂ "
HT-4W-120	58- ³ / ₈ "	30- ¹ / ₂ "
HT-4W-120B	58- ³ / ₈ "	30- ¹ / ₂ "